

Proizvodni program
Georg Fischer

iJOINT
mehani ki spojni elementi



Proizvođač:



GEORG FISCHER
PIPING SYSTEMS

Georg Fischer Piping Systems Ltd.

Ebnatstrasse 111
CH-8201 Schaffhausen
Švicarska

www.georgfischer.com
www.piping.georgfischer.com



**Zastupnik i ovlaštteni servis
za Hrvatsku:**



PTMG d.o.o.

Gornjostupnička 18
10255 Stupnik

T: 01 65 88 772
F: 01 65 88 544

www.ptmg.hr



SADRŽAJ

iJOINT Mehani ki spojni elementi

Spojnicica sa vanjskim navojem
Spojnicica sa unutarnjim navojem
Spojnicica istostrana
Redukcija
Spojnicica za popravak
T - komad 90
T - komad reducirani 90
T - komad 90 sa vanjskim navojem
T - komad 90 sa unutarnjim navojem
Koljeno 90
Koljeno 90 sa vanjskim navojem
Koljeno 90 sa unutarnjim navojem
Koljeno 90 sa vanjskim navojem
Koljeno 45
Koljeno 45 sa vanjskim navojem
Spojnicica sa prirubnicom
Završna kapa
Ključ za zatezanje

Radni tlak	16 bara
Temperatura rada	-10 °C do +45 °C
Materijal	<p>Tijelo UV stabilizirani polipropilen</p> <p>Matica UV stabilizirani polipropilen</p> <p>Spojni prsten Poliacetal (POM)</p> <p>Brtva EPDM za pitku vodu</p> <p>Prsten za ojačavanje Neh. celik AISI 430</p>
Odobrenja za pitku vodu	<ul style="list-style-type: none"> - W270 and KTW (Germany) - ATA (Netherlands) - DM 174-06/04/2004 (Italy) - Global Mark (Australia) - ACS (France)
Odobrenja	<ul style="list-style-type: none"> - DVGW (Germany) - IIP (Italy) - SVGW (Switzerland) - KIWA (Netherlands) - ACS (France) - Global Mark (Australia)
Standardi	<p>Za PE cijevi : DIN EN 12201; ISO 11922-1; DIN 8074; EN 12201-1/2; AS/NZS 4130; BS 6572; BS 6730; ISO 4427; UNI 7990; ISO 12162</p> <p>Navoji DIN EN 10226 (ISO 7-1); BS 21; AS 1722.1</p> <p>Prirubnice DIN EN1092-1; DIN 2501.1</p>
Test standardi	ISO 14236; DIN 8076-3; AS/NZS 4129; BRL K534/03 -UNI; ISO 3501; ISO 3503; ISO 3458; ISO 3459; VP609



iJOINT Instalacija



Uštedite vrijeme, ne otvarajte iJOINT spojnicu!

Upute

Ø 20 - 63mm

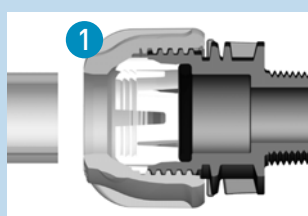

1 Odrežite i izravajte cijev.

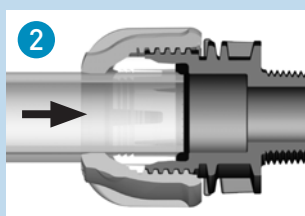

2 Gurnite cijev u fitting do prvog zaustavljanja, što znači da je cijev došla do brtve.

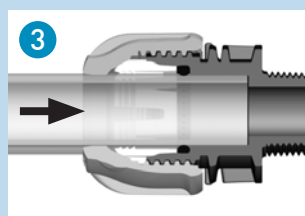

3 Još jednom gurnite cijev kako bi prošla brtvu i došla do kraja fittinga.

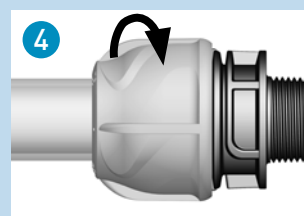

4 Zategnite maticu rukom i napravite još jedan krug koristeći Georg Fischer ključ.

Ø 75 - 110mm

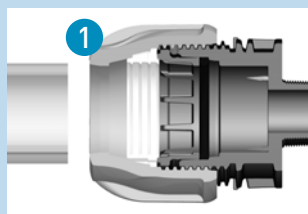

1 Odrežite i izravajte cijev.

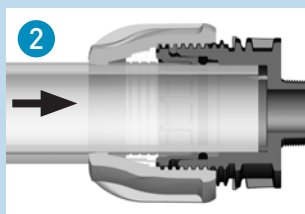

2 Gurnite cijev u fitting do kraja.

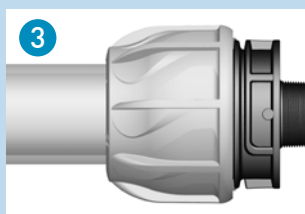

3 Zategnite maticu koristeći Georg Fischer ključ.

Dubina umetanja

Fitinzi

Ø	20	25	32	40	50	63
mm	51	56	63	73	84	99

Fitinzi sa prirubnicom

Ø	50	63
mm	102	118

IJOINT MEHANI KI SPOJNI ELEMENTI

Spojnica sa vanjskim navojem



- instalacija bez rastavljanja
- pogodno za PE i PEX cijevi
- voda, PN 16
- materijal PP
- boja: plavo-crna

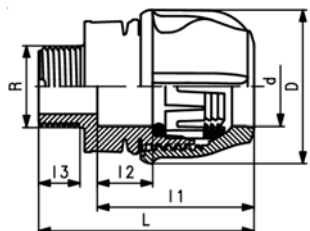

d	R	PN	Kod	SP	GP	kg	D	L	I1	I2	I3
[mm]	[inch]						[mm]	[mm]	[mm]	[mm]	[mm]
20	½	16	158 500 123	25	350	0.038	45	73	54	19	14
20	¾	16	158 500 124	25	325	0.039	45	74	54	19	15
20	1	16	158 500 125	25	300	0.041	45	77	54	19	17
25	½	16	158 500 126	25	200	0.055	53	79	59	21	14
25	¾	16	158 500 127	25	200	0.056	53	80	59	21	15
25	1	16	158 500 128	25	200	0.059	53	83	59	21	17
32	¾	16	158 500 129	25	125	0.089	64	88	66	23	15
32	1	16	158 500 130	25	125	0.091	64	91	66	23	17
32	1 ¼	16	158 500 131	25	125	0.094	64	93	66	23	20
32	1 ½	16	158 500 132	25	125	0.098	64	93	66	23	20
40	1	16	158 500 133	70	-	0.140	75	102	76	26	17
40	1 ¼	16	158 500 134	70	-	0.143	75	104	76	26	20
40	1 ½	16	158 500 135	70	-	0.145	75	104	76	26	20
40	2	16	158 500 136	60	-	0.155	75	109	76	26	24
50	1	16	158 500 137	40	-	0.243	97	114	88	30	17
50	1 ¼	16	158 500 138	40	-	0.245	97	117	88	30	20
50	1 ½	16	158 500 139	40	-	0.247	97	117	88	30	20
50	2	16	158 500 140	40	-	0.251	97	121	88	30	24
63	1 ½	16	158 500 141	20	-	0.434	114	135	104	35	20
63	2	16	158 500 142	20	-	0.437	114	139	104	35	24
63	2 ½	16	158 500 143	20	-	0.445	114	143	104	35	28
75	2	16	158 500 144	18	-	0.778	135	170	133	41	24
75	2 ½	16	158 500 145	18	-	0.784	135	174	133	41	28
75	3	16	158 500 146	18	-	0.791	135	177	133	41	30
90	2	16	158 500 147	8	-	1.134	161	189	150	44	24
90	2 ½	16	158 500 148	8	-	1.139	161	193	150	44	28
90	3	16	158 500 149	8	-	1.144	161	196	150	44	30
90	4	16	158 500 150	8	-	1.201	161	202	150	44	36
110	3	16	158 500 151	6	-	1.829	185	222	175	53	30
110	4	16	158 500 152	6	-	1.854	185	228	175	53	36

PF 2 85 A07 001

Spojnica sa unutarnjim navojem



- sa prstenom za ojačavanje
- instalacija bez rastavljanja
- pogodno za PE i PEX cijevi
- voda, PN 16
- materijal PP
- boja: plavo-crna

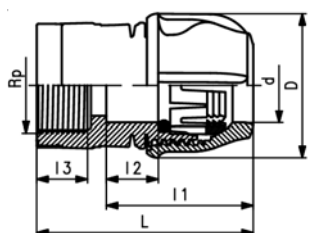

d	Rp	PN	Kod	SP	GP	kg	D	L	I1	I2	I3
[mm]	[inch]						[mm]	[mm]	[mm]	[mm]	[mm]
20	½	16	158 500 088	25	325	0.043	45	75	54	19	15
20	¾	16	158 500 089	25	300	0.047	45	77	54	19	16
25	½	16	158 500 090	25	175	0.061	53	81	59	21	15
25	¾	16	158 500 091	25	175	0.064	53	81	59	21	16
25	1	16	158 500 092	25	150	0.074	53	87	59	21	20
32	¾	16	158 500 093	25	125	0.092	64	90	66	23	16
32	1	16	158 500 094	25	125	0.103	64	94	66	23	20
32	1 ¼	16	158 500 095	25	125	0.118	64	97	66	23	22
40	1	16	158 500 096	70	-	0.152	75	105	76	26	20
40	1 ¼	16	158 500 097	70	-	0.163	75	107	76	26	22
40	1 ½	16	158 500 098	70	-	0.175	75	108	76	26	22

tablica se nastavlja

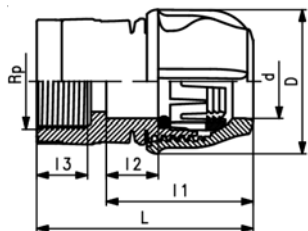

d [mm]	Rp [inch]	PN	Kod	SP	GP	kg	D [mm]	L [mm]	I1 [mm]	I2 [mm]	I3 [mm]
50	1	16	158 500 099	40	-	0.255	97	117	88	30	20
50	1 ¼	16	158 500 100	40	-	0.265	97	119	88	30	22
50	1 ½	16	158 500 101	40	-	0.270	97	119	88	30	22
50	2	16	158 500 102	40	-	0.306	97	125	88	30	26
63	1 ½	16	158 500 103	20	-	0.456	114	137	104	35	22
63	2	16	158 500 104	20	-	0.480	114	141	104	35	26
63	2 ½	16	158 500 105	18	-	0.535	114	148	104	35	31
75	2	16	158 500 106	18	-	0.821	135	173	133	41	26
75	2 ½	16	158 500 107	18	-	0.860	135	178	133	41	2
75	3	10	158 500 108	16	-	0.934	135	183	133	41	34
90	2	16	158 500 109	8	-	1.179	161	192	150	44	26
90	2 ½	16	158 500 110	8	-	1.209	161	197	150	44	31
90	3	10	158 500 111	8	-	1.258	161	199	150	44	34
110	3	10	158 500 112	6	-	1.941	185	226	175	53	34
110	4	10	158 500 113	6	-	2.043	185	232	175	53	40

PF 2 85 A07 001

Spojnica



- instalacija bez rastavljanja
- pogodno za PE i PEX cijevi
- voda, PN 16
- materijal PP
- boja: plavo-crna

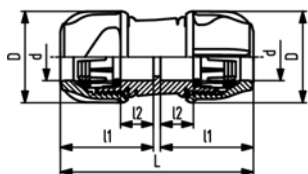

d [mm]	PN	Kod	SP	GP	kg	D [mm]	L [mm]	I1 [mm]	I2 [mm]
20	16	158 500 001	25	175	0.066	45	112	54	19
25	16	158 500 002	25	100	0.098	53	123	59	21
32	16	158 500 003	25	50	0.155	64	138	66	23
40	16	158 500 004	35	-	0.243	75	157	76	26
50	16	158 500 005	25	-	0.424	97	181	88	30
63	16	158 500 006	15	-	0.750	114	213	104	35
75	16	158 500 007	12	-	1.370	135	273	133	41
90	16	158 500 008	4	-	1.980	161	306	150	44
110	16	158 500 009	3	-	4.309	185	358	175	53

PF 2 85 A07 001

Redukcija



- instalacija bez rastavljanja
- pogodno za PE i PEX cijevi
- voda, PN 16
- materijal PP
- boja: plavo-crna

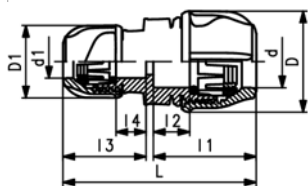

d-d [mm]	PN	Kod	SP	GP	kg
25 - 20	16	158 500 153	25	125	0.039
32 - 20	16	158 500 154	25	75	0.054
32 - 25	16	158 500 155	25	75	0.060
40 - 25	16	158 500 156	50	-	0.083
40 - 32	16	158 500 157	50	-	0.094
50 - 32	16	158 500 158	25	-	0.142
50 - 40	16	158 500 159	25	-	0.159
63 - 32	16	158 500 160	20	-	0.227
63 - 40	16	158 500 161	20	-	0.247
63 - 50	16	158 500 162	15	-	0.281
75 - 50	16	158 500 163	12	-	0.438
75 - 63	16	158 500 164	12	-	0.503
90 - 63	16	158 500 165	6	-	0.665
90 - 75	16	158 500 166	6	-	0.796
110 - 90	16	158 500 167	3	-	1.236

tablica se nastavlja

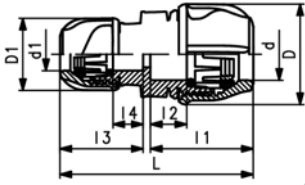

d-d [mm]	d [mm]	d1 [mm]	D [mm]	D1 [mm]	L [mm]	I1 [mm]	I2 [mm]	I3 [mm]	I4 [mm]
25 - 20	25	20	53	45	117	59	21	54	19
32 - 20	32	20	64	45	130	66	23	54	19
32 - 25	32	25	64	53	130	66	23	59	21
40 - 25	40	25	75	53	160	76	26	59	21
40 - 32	40	32	75	64	164	76	26	66	23
50 - 32	50	32	97	64	175	88	30	66	23
50 - 40	50	40	97	75	204	88	30	76	26
63 - 32	63	32	114	64	210	104	35	66	23
63 - 40	63	40	114	75	216	104	35	76	26
63 - 50	63	50	114	97	216	104	35	88	30
75 - 50	75	50	135	97	237	133	41	88	30
75 - 63	75	63	135	114	249	133	41	104	35
90 - 63	90	63	161	114	292	150	44	104	35
90 - 75	90	63	161	135	366	150	44	133	41
110 - 90	110	90	185	161	363	175	53	150	44

PF 2 85 A07 001

Spojnica za popravak



- instalacija bez rastavljanja
- pogodno za PE i PEX cijevi
- voda, PN 16
- materijal PP
- boja: plavo-crna

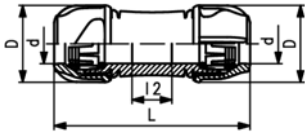

d [mm]	PN	Kod	SP	GP	kg	D [mm]	L [mm]	I2 [mm]
20	16	158 500 168	25	175	0.071	45	129	21
25	16	158 500 169	25	100	0.108	53	144	25
32	16	158 500 170	25	50	0.172	63	165	33
40	16	158 500 171	35	-	0.278	75	193	41
50	16	158 500 172	25	-	0.488	97	225	50
63	16	158 500 173	15	-	0.879	114	270	63
75	16	158 500 174	12	-	1.574	135	340	74
90	16	158 500 175	5	-	2.329	161	394	90
110	16	158 500 176	3	-	3.793	185	464	110

PF 2 85 A07 001

T-komad 90°



- instalacija bez rastavljanja
- pogodno za PE i PEX cijevi
- voda, PN 16
- materijal PP
- boja: plavo-crna

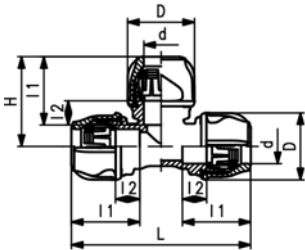

d [mm]	PN	Kod	SP	GP	kg	D [mm]	L [mm]	I1 [mm]	I2 [mm]	H [mm]
20	16	158 500 223	25	100	0.099	45	134	54	19	67
25	16	158 500 224	25	50	0.151	53	150	59	21	75
32	16	158 500 225	15	30	0.245	64	173	66	23	87
40	16	158 500 226	20	-	0.391	75	203	76	26	102
50	16	158 500 227	12	-	0.685	97	239	88	30	119
63	16	158 500 228	6	-	1.241	114	288	104	35	144
75	16	158 500 229	5	-	2.236	135	360	133	41	180
90	16	158 500 230	2	-	3.324	161	413	150	44	207
110	16	158 500 231	1	-	5.347	185	484	175	53	242

PF 2 85 A07 001



T-komad reducirani 90°

- instalacija bez rastavljanja
- pogodno za PE i PEX cijevi
- voda, PN 16
- materijal PP
- boja: plavo-crna

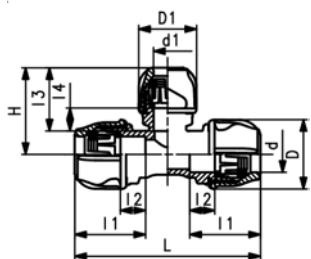

d-d-d [mm]	PN	Kod	SP	GP	kg
20 - 25 - 20	16	158 500 200	25	75	0.118
25 - 20 - 25	16	158 500 232	25	50	0.061
25 - 32 - 25	16	158 500 201	15	30	0.164
32 - 25 - 32	16	158 500 233	15	30	0.098
40 - 32 - 40	16	158 500 234	20	-	0.158
50 - 32 - 50	16	158 500 235	15	-	0.251
50 - 40 - 50	16	158 500 236	12	-	0.271
63 - 32 - 63	16	158 500 237	8	-	0.430
63 - 50 - 63	16	158 500 238	8	-	0.488
75 - 63 - 75	16	158 500 239	5	-	0.880
90 - 75 - 90	16	158 500 240	2	-	1.370
110 - 63 - 110	16	158 500 241	1	-	1.976
110 - 90 - 110	16	158 500 242	1	-	2.164

d-d-d [mm]	d [mm]	d1 [mm]	D [mm]	D1 [mm]	L [mm]	I1 [mm]	I2 [mm]	I3 [mm]	I4 [mm]	H [mm]
20 - 25 - 20	20	25	45	53	134	54	19	59	21	81
25 - 20 - 25	25	20	53	45	150	59	21	54	19	71
25 - 32 - 25	25	32	53	64	150	59	21	66	23	93
32 - 25 - 32	32	25	64	53	173	66	23	59	21	81
40 - 32 - 40	40	32	75	64	203	76	26	66	23	93
50 - 32 - 50	50	32	97	64	239	88	30	66	23	99
50 - 40 - 50	50	40	97	75	239	88	30	76	26	109
63 - 32 - 63	63	32	114	64	288	104	35	66	23	108
63 - 50 - 63	63	50	114	97	288	104	35	88	30	129
75 - 63 - 75	75	63	135	114	360	133	41	104	35	157
90 - 75 - 90	90	75	161	135	413	150	44	133	41	196
110 - 63 - 110	110	63	185	114	484	175	53	104	35	182
110 - 90 - 110	110	90	185	161	484	175	53	150	44	224

PF 2 85 A07 001



T-komad sa vanjskim navojem 90°

- instalacija bez rastavljanja
- pogodno za PE i PEX cijevi
- voda, PN 16
- materijal PP
- boja: plavo-crna

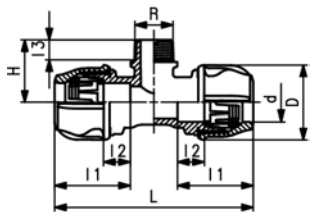

d [mm]	R [inch]	PN	Kod	SP	GP	kg	D [mm]	L [mm]	I1 [mm]	I2 [mm]	I3 [mm]	H [mm]
20	½	16	158 500 202	25	125	2.157	45	134	54	19	14	41
20	¾	16	158 500 203	25	125	2.157	45	134	54	19	15	42
25	½	16	158 500 204	25	75	2.177	53	150	59	21	14	44
25	¾	16	158 500 205	25	75	2.177	53	150	59	21	15	46
25	1	16	158 500 206	25	75	0.117	53	150	59	21	17	48
32	¾	16	158 500 207	15	45	0.180	64	173	66	23	15	51
32	1	16	158 500 208	15	45	0.184	64	173	66	21	17	53
40	¾	16	158 500 209	30	-	0.282	75	203	76	26	15	57
40	1 ¼	16	158 500 210	30	-	0.297	75	203	76	26	20	62
40	1 ½	16	158 500 211	30	-	0.304	75	203	76	26	20	62
50	¾	16	158 500 212	16	-	0.489	97	239	88	30	15	65
50	1 ¼	16	158 500 213	16	-	0.501	97	239	88	30	20	70
50	1 ½	16	158 500 214	16	-	0.511	97	239	88	30	20	70
63	1 ¼	16	158 500 215	8	-	0.899	114	288	104	35	20	81
63	1 ½	16	158 500 216	8	-	0.905	114	288	104	35	20	81
63	2	16	158 500 217	8	-	0.924	114	288	104	35	24	85

tablica se nastavlja

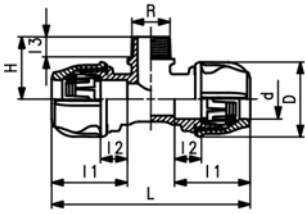

d [mm]	R [inch]	PN	Kod	SP	GP	kg	D [mm]	L [mm]	I1 [mm]	I2 [mm]	I3 [mm]	H [mm]
63	2 ½	16	158 500 218	8	-	0.958	114	288	104	35	28	89
75	2 ½	16	158 500 219	7	-	1.661	135	360	133	41	28	101
75	3	16	158 500 220	6	-	1.738	135	360	133	41	30	104
90	3	16	158 500 221	2	-	2.478	161	413	150	44	30	116
110	4	16	158 500 222	2	-	4.035	185	484	175	53	36	138

PF 2 85 A07 001

T-komad sa unutarnjim navojem 90°



- sa prstenom za ojačanje
- instalacija bez rastavljanja
- pogodno za PE i PEX cijevi
- voda, PN 16
- materijal PP
- boja: plavo-crna

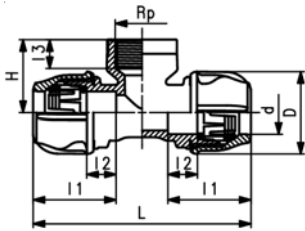

d [mm]	Rp [inch]	PN	Kod	SP	GP	kg	D [mm]	L [mm]	I1 [mm]	I2 [mm]	I3 [mm]	H [mm]
20	½	16	158 500 177	25	125	0.078	45	134	54	19	15	40
20	¾	16	158 500 178	25	125	0.083	45	134	54	19	16	41
25	½	16	158 500 179	25	75	0.111	53	150	59	21	15	40
25	¾	16	158 500 180	25	75	0.119	53	150	59	21	16	44
25	1	16	158 500 181	25	75	0.123	53	150	59	21	20	49
32	½	16	158 500 182	15	45	0.176	64	173	66	23	15	42
32	¾	16	158 500 183	15	45	0.182	64	173	66	23	16	46
32	1	16	158 500 184	15	45	0.191	64	173	66	23	20	54
32	1 ¼	16	158 500 185	15	45	0.210	64	173	66	23	22	57
40	¾	16	158 500 186	35	-	0.283	75	203	76	26	16	49
40	1	16	158 500 187	35	-	0.295	75	203	76	26	20	57
40	1 ¼	16	158 500 188	35	-	0.316	75	203	76	26	22	62
40	1 ½	16	158 500 189	35	-	0.327	75	206	76	26	22	63
50	1	16	158 500 190	22	-	0.504	97	239	88	30	20	61
50	1 ¼	16	158 500 191	22	-	0.520	97	239	88	30	22	66
50	1 ½	16	158 500 192	22	-	0.537	97	171	88	30	22	70
50	2	16	158 500 193	18	-	0.574	97	239	88	30	26	75
63	1 ¼	16	158 500 194	10	-	0.909	114	288	104	35	22	73
63	1 ½	16	158 500 195	10	-	0.930	114	288	104	35	22	76
63	2	16	158 500 196	10	-	0.969	114	207	104	35	26	83
75	2 ½	16	158 500 197	6	-	1.749	135	360	133	41	31	101
90	3	10	158 500 198	3	-	2.620	161	413	150	44	34	116
110	4	10	158 500 199	2	-	4.256	185	484	175	53	40	135

PF 2 85 A07 001



Koljeno 90°

- instalacija bez rastavljanja
- pogodno za PE i PEX cijevi
- voda, PN 16
- materijal PP
- boja: plavo-crna

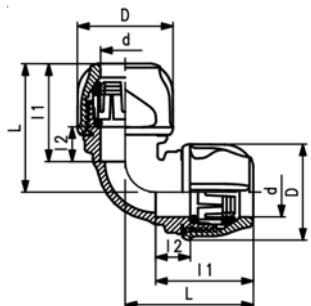

d [mm]	PN	Kod	SP	GP	kg	D [mm]	L [mm]	I1 [mm]	I2 [mm]
20	16	158 500 070	25	150	0.067	45	67	54	19
25	16	158 500 071	25	100	0.101	53	75	59	21
32	16	158 500 072	25	50	0.165	64	87	66	23
40	16	158 500 073	30	-	0.265	75	102	76	26
50	16	158 500 074	20	-	0.462	97	119	88	30
63	16	158 500 075	10	-	0.837	114	144	104	35
75	16	158 500 076	8	-	1.507	135	180	133	41
90	16	158 500 077	3	-	2.237	161	207	150	44
110	16	158 500 078	2	-	3.587	185	242	175	53

PF 2 85 A07 001



Koljeno 90° sa vanjskim navojem

- instalacija bez rastavljanja
- pogodno za PE i PEX cijevi
- voda, PN 16
- materijal PP
- boja: plavo-crna

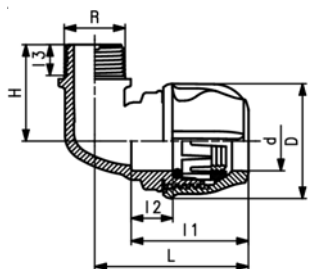

d [mm]	R [inch]	PN	Kod	SP	GP	kg	D [mm]	L [mm]	I1 [mm]	I2 [mm]	I3 [mm]	H [mm]
20	½	16	158 500 047	25	200	0.041	45	67	54	19	14	41
20	¾	16	158 500 048	25	200	0.043	45	67	54	19	15	42
25	½	16	158 500 049	25	150	0.059	53	75	59	21	14	44
25	¾	16	158 500 050	25	150	0.063	53	75	59	21	15	46
25	1	16	158 500 051	25	150	0.068	53	75	59	21	17	48
32	½	16	158 500 052	25	100	0.095	64	87	66	23	14	49
32	¾	16	158 500 053	25	100	0.098	64	87	66	23	15	51
32	1	16	158 500 054	25	100	0.105	64	87	66	23	17	53
40	1	16	158 500 055	50	-	0.161	75	102	76	26	17	60
40	1 ¼	16	158 500 056	50	-	0.175	75	102	75	26	20	62
40	1 ½	16	158 500 057	50	-	0.175	75	102	75	26	20	62
50	1 ¼	16	158 500 058	40	-	0.280	97	119	88	30	20	70
50	1 ½	16	158 500 059	35	-	0.290	97	117	88	30	20	70
63	1 ¼	16	158 500 060	15	-	0.485	114	144	104	35	20	81
63	1 ½	16	158 500 061	15	-	0.492	114	144	104	35	20	81
63	2	16	158 500 062	15	-	0.527	114	144	104	35	24	85
63	2 ½	16	158 500 063	15	-	0.555	114	144	104	35	28	89
75	2 ½	16	158 500 064	12	-	0.948	135	180	133	41	28	101
75	3	16	158 500 065	10	-	0.969	135	180	133	41	30	104
90	3	16	158 500 066	5	-	1.421	161	207	150	44	30	116
90	4	16	158 500 067	4	-	1.504	161	207	150	44	36	122
110	3	16	158 500 068	2	-	2.174	185	242	175	53	30	131
110	4	16	158 500 069	2	-	2.322	185	242	175	53	36	138

PF 2 85 A07 001



Koljeno 90° sa unutarnjim navojem

- sa prstenom za ojačavanje
- instalacija bez rastavljanja
- pogodno za PE i PEX cijevi
- voda, PN 16
- materijal PP
- boja: plavo-crna

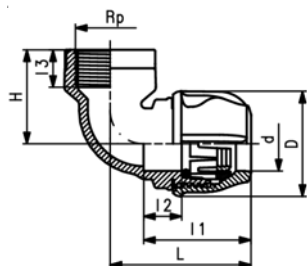

d [mm]	Rp [inch]	PN	Kod	SP	GP	kg	D [mm]	L [mm]	I1 [mm]	I2 [mm]	I3 [mm]	H [mm]
20	½	16	158 500 022	25	200	0.046	45	67	54	19	15	40
20	¾	16	158 500 023	25	200	0.050	45	67	54	19	16	40
25	½	16	158 500 024	25	150	0.062	53	75	59	21	15	40
25	¾	16	158 500 025	25	150	0.070	53	75	59	21	16	44
25	1	16	158 500 026	25	125	0.066	53	75	59	21	20	49
32	½	16	158 500 027	25	100	0.096	64	87	66	23	15	43
32	¾	16	158 500 028	25	100	0.106	64	87	66	23	16	46
32	1	16	158 500 029	25	100	0.117	64	87	66	23	20	54
32	1 ¼	16	158 500 030	25	75	0.131	64	87	66	23	22	57
40	¾	16	158 500 031	50	-	0.160	75	102	76	26	16	49
40	1	16	158 500 032	50	-	0.178	75	102	76	26	20	57
40	1 ¼	16	158 500 033	50	-	0.190	75	102	76	26	22	62
40	1 ½	16	158 500 034	50	-	0.202	75	102	76	26	22	63
50	1	16	158 500 035	30	-	0.281	97	119	88	30	20	61
50	1 ¼	16	158 500 036	30	-	0.300	97	119	88	30	22	66
50	1 ½	16	158 500 037	30	-	0.302	97	119	88	30	22	70
50	2	16	158 500 038	30	-	0.348	97	119	88	30	26	75
63	1 ¼	16	158 500 039	15	-	0.502	114	144	104	35	22	73
63	1 ½	16	158 500 040	15	-	0.528	114	144	104	35	22	76
63	2	16	158 500 041	15	-	0.567	114	144	104	35	26	83
75	2	16	158 500 042	12	-	0.949	135	180	133	41	26	91
75	2 ½	16	158 500 043	12	-	1.013	135	180	133	41	31	101
75	3	10	158 500 044	10	-	1.105	135	180	133	41	34	108
90	3	10	158 500 045	6	-	1.525	161	207	150	44	34	116
110	4	10	158 500 046	3	-	2.482	185	242	175	53	40	135

PF 2 85 A07 001



Koljeno 45°

- instalacija bez rastavljanja
- pogodno za PE i PEX cijevi
- voda, PN 16
- materijal PP
- boja: plavo-crna

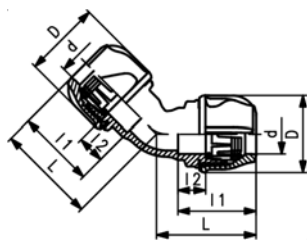

d [mm]	PN	Kod	SP	GP	kg	D [mm]	L [mm]	I1 [mm]	I2 [mm]
20	16	158 500 016	25	150	0.067	45	65	54	19
25	16	158 500 017	25	100	0.103	53	82	59	21
32	16	158 500 018	25	50	0.167	64	84	66	23
40	16	158 500 019	30	-	0.264	75	96	76	26
50	16	158 500 020	20	-	0.466	97	113	88	30
63	16	158 500 021	10	-	0.836	114	133	104	35

PF 2 85 A07 001



Koljeno 45° sa vanjskim navojem

- instalacija bez rastavljanja
- pogodno za PE i PEX cijevi
- voda, PN 16
- materijal PP
- boja: plavo-crna

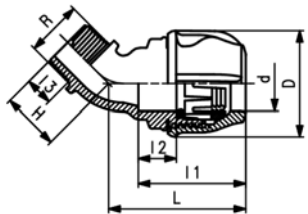

PF 2 85 A07 001

d [mm]	R [inch]	PN	Kod	SP	GP	kg	D [mm]	L [mm]	I1 [mm]	I2 [mm]	I3 [mm]	H [mm]
20	1/2	16	158 500 010	25	200	0.038	45	65	54	19	14	26
25	3/4	16	158 500 011	25	150	0.059	53	75	59	21	15	30
32	1	16	158 500 012	25	75	0.098	64	84	66	23	17	35
40	1 1/4	16	158 500 013	50	-	0.157	75	96	76	26	20	41
50	1 1/2	16	158 500 014	35	-	0.269	97	113	88	30	20	44
63	2	16	158 500 015	20	-	0.482	114	133	104	35	24	53



Spojnica sa priрубnicom

- instalacija bez rastavljanja
- pogodno za PE i PEX cijevi
- voda, PN 16
- materijal PP
- boja: plavo-crna

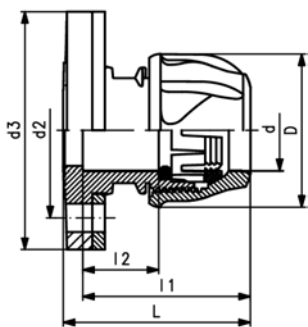

PF 2 85 A07 001

d [mm]	DN [inch]	DN [mm]	PN	Kod	SP	GP	kg	D [mm]	d2 [mm]	d3 [mm]	L [mm]	I1 [mm]	I2 [mm]
50	1 1/2	40	16	158 500 114	16	-	1.134	97	110	150	118	88	30
50	2	50	16	158 500 115	16	-	1.159	97	125	160	119	88	30
63	2	50	16	158 500 116	12	-	1.304	114	125	160	13	104	35
63	2 1/2	65	16	158 500 117	12	-	1.728	114	145	187	137	104	35
75	2 1/2	65	16	158 500 118	8	-	2.016	135	145	187	170	133	41
75	3	80	16	158 500 119	6	-	2.170	135	160	205	168	133	41
90	3	80	16	158 500 120	5	-	2.469	161	160	205	192	150	44
90	4	100	16	158 500 121	5	-	2.892	161	180	220	195	150	44
110	4	100	16	158 500 122	4	-	3.442	185	180	220	223	175	53



Završna kapa

- instalacija bez rastavljanja
- pogodno za PE i PEX cijevi
- voda, PN 16
- materijal PP
- boja: plavo-crna

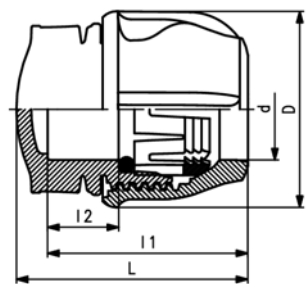

PF 2 85 A07 001

d [mm]	PN	Kod	SP	GP	kg	D [mm]	L [mm]	I1 [mm]	I2 [mm]
20	16	158 500 079	25	350	0.036	45	60	54	19
25	16	158 500 080	25	200	0.054	53	67	59	21
32	16	158 500 081	25	125	0.087	64	76	66	23
40	16	158 500 082	60	-	0.138	75	89	76	26
50	16	158 500 083	40	-	0.243	97	104	88	30
63	16	158 500 084	20	-	0.437	114	124	104	35
75	16	158 500 085	18	-	0.780	135	155	133	41
90	16	158 500 086	8	-	1.152	161	178	150	44
110	16	158 500 087	6	-	1.869	185	209	175	53

Metalni ključ za zatezanje



PF 2 85 511 000

d-d [mm]	Kod	SP	GP	kg	L [mm]	L1 [mm]	
20 - 75	158 500 998	2	-	0.626	540	115	
63 - 110	158 500 999	2	-	1.642	659	162	

GF Piping Systems → worldwide at home

Our sales companies and representatives ensure local customer support in over 100 countries.

www.piping.georgfischer.com



Adding Quality to People's Lives

Australia

George Fischer Pty Ltd
Riverwood NSW 2210 Australia
Phone +61(0)2 9502 8000
australia.ps@georgfischer.com
www.georgfischer.com.au

Austria

Georg Fischer
Rohrleitungssysteme GmbH
3130 Herzogenburg
Phone +43(0)2782 856 43-0
austria.ps@georgfischer.com
www.georgfischer.at

Georg Fischer Fittings GmbH
3160 Traisen
Phone +43 (0)2762 90300
fittings.ps@georgfischer.com
www.fittings.at

Belgium/Luxembourg

Georg Fischer NV/SA
1070 Bruxelles/Brüssel
Phone +32(0)2 556 40 20
be.ps@georgfischer.com
www.georgfischer.be

Brazil

George Fischer Ltda
04795-100 São Paulo
Phone +55(0)11 5687 1311
br.ps@georgfischer.com

Croatia

PTMG d.o.o.
Gornjostupnicka 18
10255 Stupnik
Phone +385 (1) 65 88 772
ptmg@ptmg.hr
www.ptmg.hr

Denmark/Iceland

Georg Fischer A/S
2630 Taastrup
Phone +45 (0)70 22 19 75
info.dk.ps@georgfischer.com
www.georgfischer.dk

France

Georg Fischer SAS
95932 Roissy Charles de Gaulle Cedex
Phone +33(0)1 41 84 68 84
fr.ps@georgfischer.com
www.georgfischer.fr

Germany

Georg Fischer GmbH
73095 Albershausen
Phone +49(0)7161 302-0
info.de.ps@georgfischer.com
www.georgfischer.de

India

Georg Fischer Piping Systems Ltd
400 076 Mumbai
Phone +91 224007 2001
in.ps@georgfischer.com
www.georgfischer.in

Italy

Georg Fischer S.p.A.
20063 Cernusco S/N (MI)
Phone +3902 921 861
it.ps@georgfischer.com
www.georgfischer.it

Georg Fischer TPA Srl

Via Bonazzi, 32
IT-40013 Castel Maggiore (BO)
Phone +39 051 632 42 11
tpa.ps@georgfischer.com
www.alprene.com

Japan

Georg Fischer Ltd
556-0011 Osaka,
Phone +81(0)6 6635 2691
jp.ps@georgfischer.com
www.georgfischer.jp

Korea

Georg Fischer Piping Systems
Guro-3 dong, Guro-gu, Seoul, Korea
Phone +82(0)2 2081 1450
Fax +82(0)2 2081 1453
kor.ps@georgfischer.com

Malaysia

Georg Fischer (M) Sdn. Bhd.
40460 Shah Alam, Selangor Darul Ehsan
Phone +60 (0)3 5122 5585
my.ps@georgfischer.com

Mexico

Georg Fischer S.A. de C.V.
Apodaca, Nuevo Leon
CP66636 Mexico
Phone +52 (81)1340 8586
Fax +52 (81)1522 8906

Middle East

Georg Fischer Piping Systems
Dubai, United Arab Emirates
Phone +971 4 289 49 60
info.export@georgfischer.com
www.export.georgfischer.com

Netherlands

Georg Fischer N.V.
8161 PA Epe
Phone +31(0)578 678 222
nl.ps@georgfischer.com
www.georgfischer.nl

Georg Fischer WAGA NV

NL-8160 AG Epe
Phone +31 (0)578 678 378
waga.ps@georgfischer.com
www.waga.nl

Norway

Georg Fischer AS
1351 Rud
Phone +47(0)67 18 29 00
no.ps@georgfischer.com
www.georgfischer.no

Poland

Georg Fischer Sp. z o.o.
02-226 Warszawa
Phone +48(0)22 313 10 50
poland.ps@georgfischer.com
www.georgfischer.pl

Romania

Georg Fischer
Piping Systems Ltd
020257 Bucharest - Sector 2
Phone +40(0)21 230 53 80
ro.ps@georgfischer.com
www.export.georgfischer.com

Russia

Georg Fischer Piping Systems
Moscow 125047
Tel. +7 495 258 60 80
ru.ps@georgfischer.com
www.georgfischer.ru

Singapore

George Fischer Pte Ltd
528 872 Singapore
Phone +65(0)67 47 06 11
sgp.ps@georgfischer.com
www.georgfischer.com.sg

Spain/Portugal

Georg Fischer S.A.
280046 Madrid
Phone +34(0)91 781 98 90
es.ps@georgfischer.com
www.georgfischer.es

Sweden/Finland

Georg Fischer AB
12523 Älvsjö-Stockholm
Phone +46(0)8 506 775 00
info.se.ps@georgfischer.com
www.georgfischer.se

Switzerland

Georg Fischer
Rohrleitungssysteme [Schweiz] AG
8201 Schaffhausen
Phone +41(0)52 631 30 26
ch.ps@georgfischer.com
www.piping.georgfischer.ch

Taiwan

Georg Fischer Piping Systems
San Chung City, Taipei Hsien
Phone +886 2 8512 2822
Fax +886 2 8512 2823

United Kingdom/Ireland

Georg Fischer Sales Limited
Coventry, CV2 2ST
Phone +44(0)2476 535 535
uk.ps@georgfischer.com
www.georgfischer.co.uk

USA/Canada/Latin America/Caribbean

Georg Fischer LLC
Tustin, CA 92780-7258
Phone +1(714) 731 88 00
Toll Free 800/854 40 90
us.ps@georgfischer.com
www.us.piping.georgfischer.com

Georg Fischer Central Plastics LLC

Shawnee, OK 74801
Phone +1(405) 273 63 02
gfccentral.ps@georgfischer.com
www.centralplastics.com

International

Georg Fischer
Piping Systems (Switzerland) Ltd.
8201 Schaffhausen/Switzerland
Phone +41(0)52 631 30 03
Fax +41(0)52 631 28 93
info.export@georgfischer.com
www.export.georgfischer.com